

ELANTRA CUSTOMER DELIVERY CHECK LIST (continued)

☐ BLUETOOTH – page 13

- Show phone compatibility website:
www.hyundaiusa.com/bluetooth
- Make a test call using customer's paired phone
- Demonstrate Voice Recognition (VR)

☐ WINDSHIELD WIPER/WASHER – page 06

- Explain wiper function (int speed, front & rear wipers) and how it may differ from customer's previous vehicle

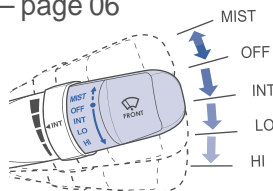

☐ CLOCK – page 19

- Demonstrate how to set clock (including daylight savings setting for Navigation equipped vehicles)

☐ UNLOCKING VEHICLE – page 02

- Demonstrate dual state unlock with key and remote keyless entry.

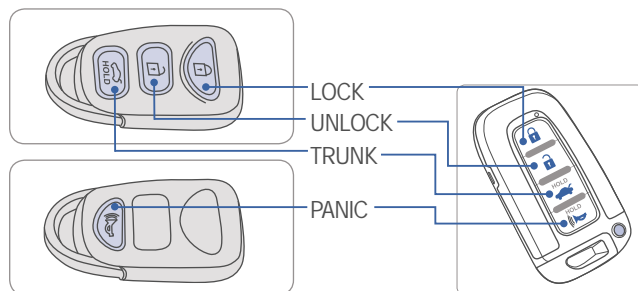

Sales Consultant	Date	Sales Manager	Date
Customer		@	Date
Email			

MAINTENANCE

Scheduled Maintenance	Normal Usage		Severe Usage*	
Engine Oil and Filter	Replace	7,500 or 12 mos.	Replace	3,750 or 6 mos.
Tire Rotation	Perform	7,500	Perform	7,500
Air Cleaner Filter	Inspect Replace	7,500 30,000	Inspect Replace	Same As Normal More Frequently
Battery Condition	Inspect	7,500	Inspect	Same As Normal
Vacuum Hose	Inspect	7,500	Inspect	Same As Normal
Climate Control Air Filter (For Evaporator and Blower Unit)	Replace	15,000	Replace	More Frequently
Air Conditioning Refrigerant	Inspect	15,000	Inspect	Same As Normal
Brake Hoses & Lines	Inspect	15,000	Inspect	Same As Normal
Drive Shafts & Boots	Inspect	15,000	Inspect	7,500 or 6 mos.
Electronic Throttle Control	Inspect	15,000	Inspect	Same As Normal
Exhaust Pipe & Muffler	Inspect	15,000	Inspect	Same As Normal
Front Brake Disc / Pads, Calipers	Inspect	15,000	Inspect	More Frequently
Rear Brake Drums / Linings Rear Brake Disc / Pads	Inspect	15,000	Inspect	More Frequently
Steering Gear Box, Linkage & Boots/ Lower Arm Ball Joint, Upper Arm Ball Joint	Inspect	15,000	Inspect	More Frequently
Suspension Mounting Bolts	Inspect	15,000	Inspect	Same As Normal
Brake/Clutch Fluid	Inspect	30,000	Inspect	Same As Normal
Fuel Filter	Inspect	30,000	Inspect	Same As Normal
Fuel Lines, Fuel Hoses and Connections	Inspect	30,000	Inspect	Same As Normal
Fuel Tank Air Filter	Inspect	30,000	Inspect	Same As Normal
Parking Brake	Inspect	30,000	Inspect	More Frequently
Vapor Hose, Fuel Tank & Fuel Filler Cap	Inspect	30,000	Inspect	Same As Normal
Manual Transmission Fluid	Inspect	37,500	Replace	75,000
Drive Belt (Alt, A/C)	1st Inspect 60,000 or 72 mos. Add'l Inspect 15,000 or 24 mos.		Inspect	Same As Normal
Spark Plugs (Iridium Coated)	Replace	100,000 or 10 yrs.	Replace	More Frequently
Coolant	1st Replace 60,000 or 6 mos. Add'l Replace 15,000 or 24 mos.		Replace	Same As Normal
Automatic Transmission Fluid	No check, No service required		Replace	60,000

*See Owner's Manual for details.

Looking for more detailed information? This Quick Reference Guide does not replace your vehicle's Owner's Manual. If you require additional information or are unsure of a specific issue, you should always refer to the vehicle's Owner's Manual or contact your authorized Hyundai dealer.

The information contained in this Quick Reference Guide was correct at the time of printing; however, specifications and equipment can change without notice. No warranty or guarantee is being extended in this Quick Reference Guide, and Hyundai reserves the right to change product specifications and equipment at any time without incurring obligations. Some vehicles are shown with optional equipment. Specifications apply to U.S. vehicles only. Please contact your Hyundai dealer for current vehicle specifications.

HYUNDAI ELANTRA

Quick Reference Guide

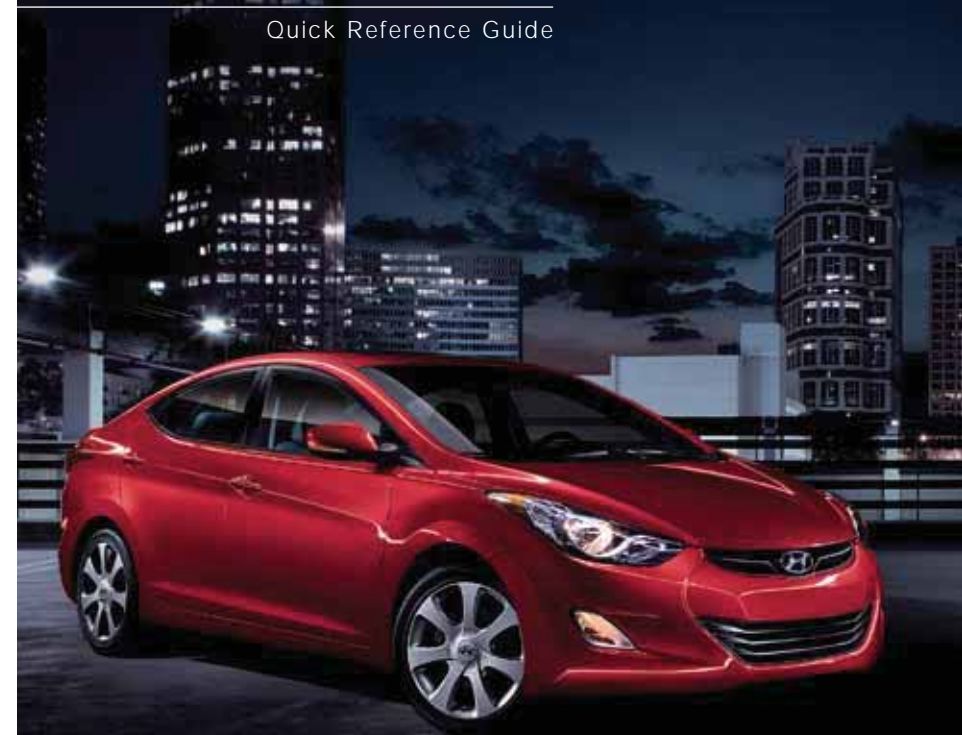

www.hyundai.com

Roadside Assistance: **1-800-243-7766**
 Consumer Affairs: **1-800-633-5151**
 XM® Radio: **1-800-967-2346**

NP150-82012-A
(Rev 09/20/11)
Printing 09/22/11

Table of contents

GETTING STARTED

Engine start/stop button	03
Front seat adjustment	02
Headrest adjustment	04
Rear seat folding	03
Remote keyless entry	02
Seat belt adjustment	04
Steering wheel adjustment	05

FEATURES AND CONTROLS

AUX, USB and iPod port	20
Child-protector rear door lock	16
Climate control	10-11
Clock adjustment	19
Driver's main controls	07
Fuel filler lid	16
Head lights and fog lights	06
Instrument cluster	08-09
Instrument panel illumination	09
Interior lights	19
Rearview camera	20
Seat warmer	18
Sunroof	17
Tire Pressure Monitoring System (TPMS)	21
Trip computer	09
Wiper and washer	06

MULTIMEDIA

Audio	12
Bluetooth phone operation	13
Navigation	14-15

DRIVING

Cruise control system	25
ECO system	24
Electronic Stability Control (ESC)	24
Transmission	22-23

How to:

Pair phone to your vehicle. Refer to page 13.

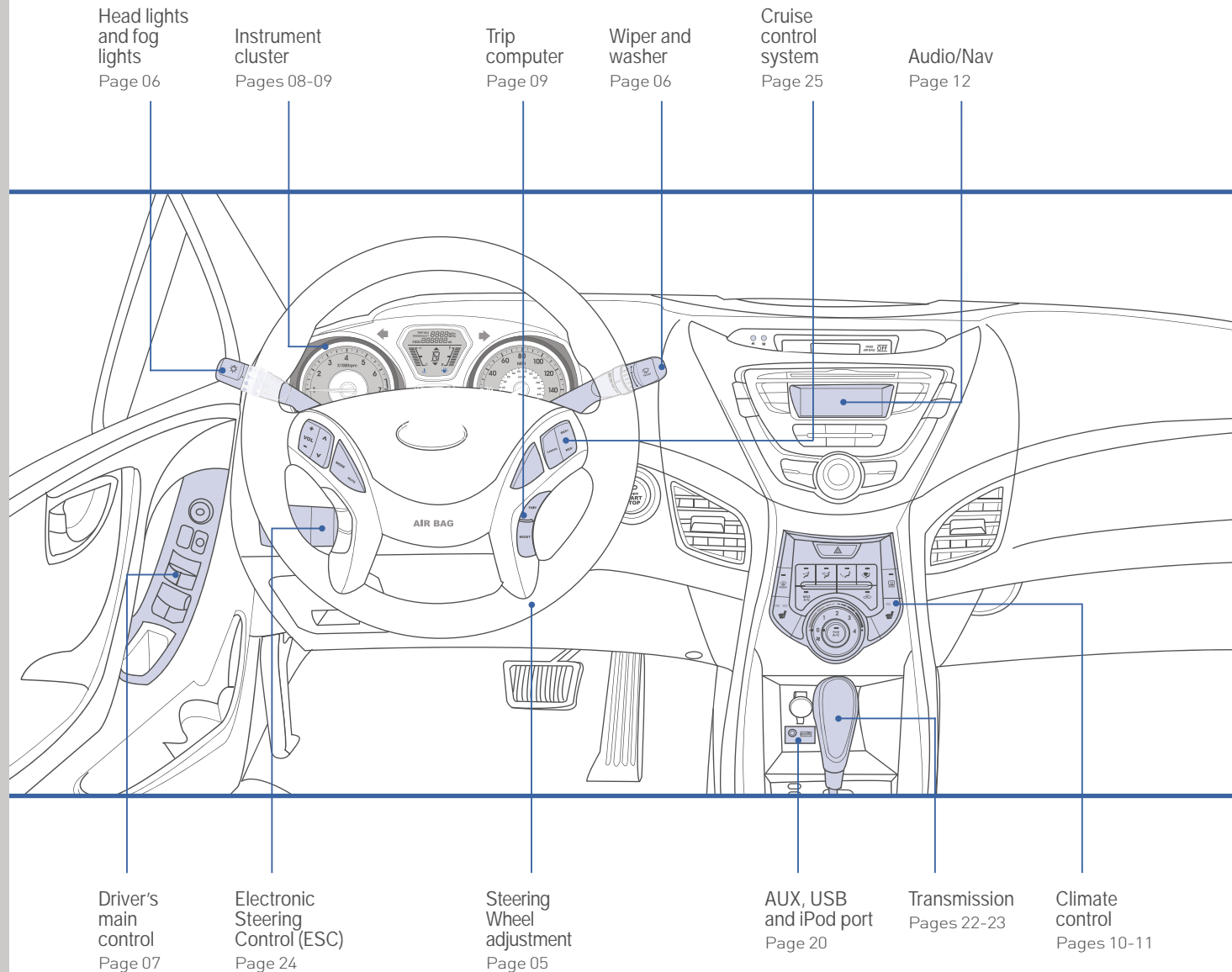

WARNING!

To reduce the risk of serious injury to yourself and others, read and understand the important SAFETY INFORMATION in your Owner's Manual.

Use this Quick Reference Guide to learn about the features that will enhance your enjoyment of your Hyundai. More detailed information about these features are available in your Owner's Manual.

*Some vehicles may not be equipped with all the listed features.



REMOTE KEYLESS ENTRY

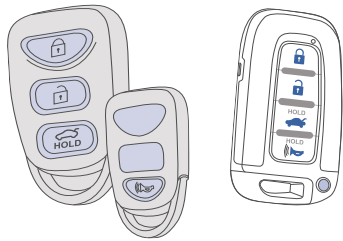

- Lock
- Unlock
- TRUNK UNLOCK
- Panic

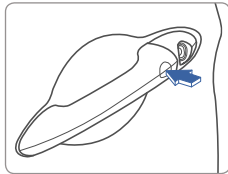

Driver's door Lock/Unlock
Smart key must be within range.

Press:

- Once – Unlock driver door
- Twice – Unlock all doors
- Third – Lock all doors

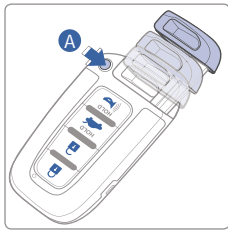

Remove mechanical key

Press and hold the release **A** button and remove the key.

Reinstall mechanical key

Put the key into the hole and push it until a click sound is heard.

FRONT SEAT ADJUSTMENT

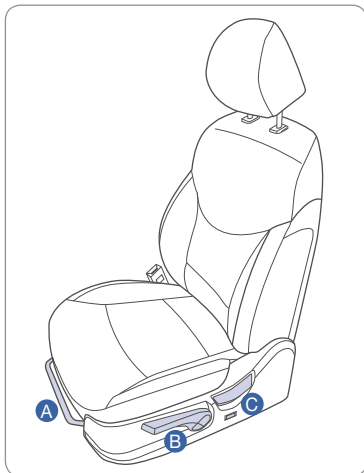

A Forward and backward



B Seat cushion height (for driver's seat)



C Seatback angle



ENGINE START/STOP BUTTON

With the ignition OFF, press the engine start/stop button:

- Once for ACC (Accessory) mode.
- Twice for ON mode.
- Three times for OFF.

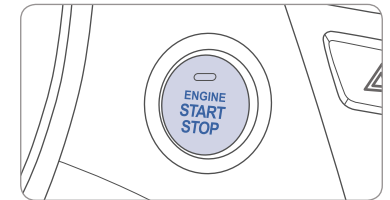

To start the engine, press the start/stop button while:

- EcoShift Dual Clutch Transmission: depressing the brake pedal.
- Manual Transmission: depressing the clutch and brake pedals.

To shut engine OFF, shift to:

- EcoShift Dual Clutch Transmission: P (Park) and press the start/stop button.
- Manual Transmission: Select 1st gear or Neutral, apply the hand brake, and press the start/stop button.

Emergency situations

• **Shut off engine while driving:**

Press engine start/stop button for more than 2 seconds or press it 3 times consecutively within 3 seconds.

• **Restart engine while driving:**

Press engine start/stop button with shift lever in N (Neutral).

REAR SEAT FOLDING

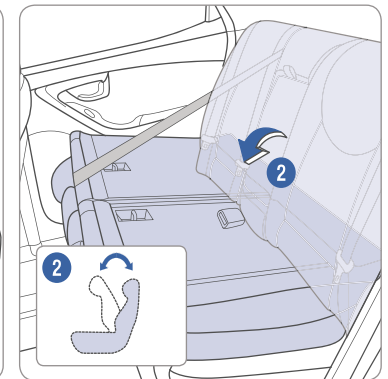
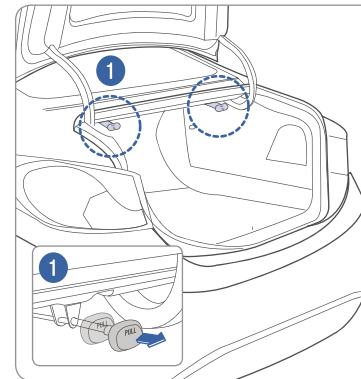



HEADREST ADJUSTMENT

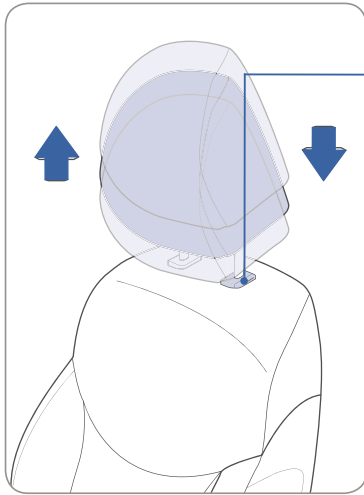

Height adjustment

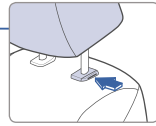

Lock knob

To raise headrest height, pull up on headrest.

To lower headrest, press lock knob while pushing down on headrest.

STEERING WHEEL ADJUSTMENT

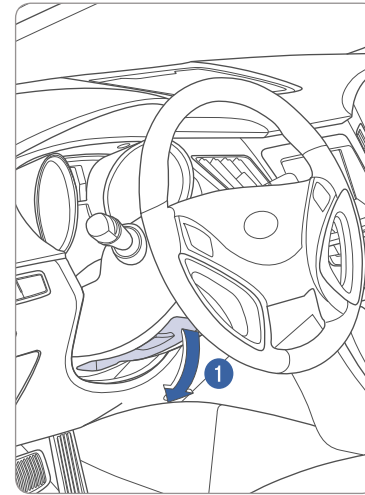

Tilt

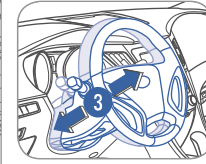

Telescopic
(if equipped)

NOTE: Do not adjust while driving.

1. Pull the lever **1** downward.
2. Set the angle **2** and distance **3** (if equipped).
3. Pull the lever **1** upward.

SEAT BELT ADJUSTMENT (Front seat)

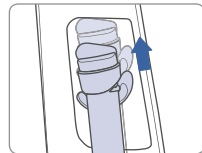
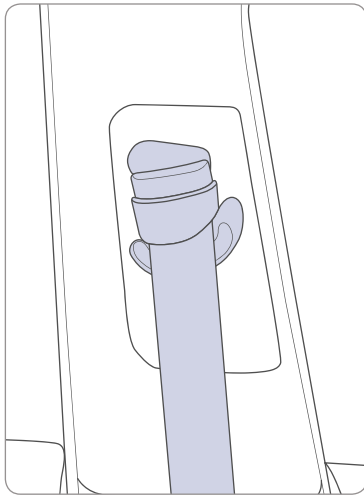

Pull up to raise.

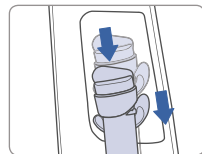

Press button and push down to lower.



FEATURES AND CONTROLS

HEAD LIGHTS AND FOG LIGHTS

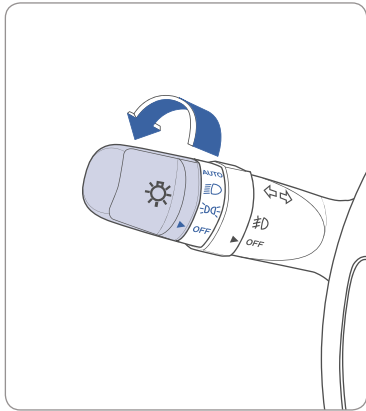

- ▶ | **AUTO** Auto light
- ▶ | Head light
- ▶ | Parking light
- ▶ | **OFF** OFF

Escort Function

Head lights may stay on for 30 seconds after exiting and locking vehicle. Press remote lock button twice to turn head lights off.

Turn signals
and lane
change signals

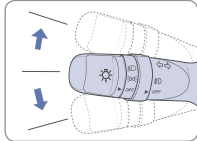

Flashing head
lights

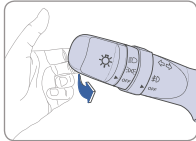

High beam

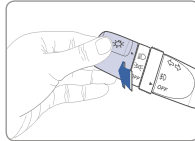

Fog light

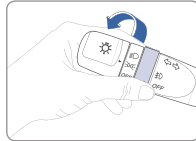

WIPER AND WASHER

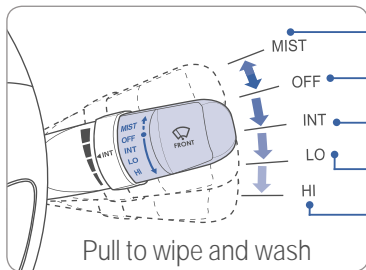

- MIST — Single wipe
- OFF — Off
- INT — Intermittent wipe
- LO — Normal wiper speed
- HI — Fast wiper speed

Pull to wipe and wash

Intermittent wipe time
adjustment

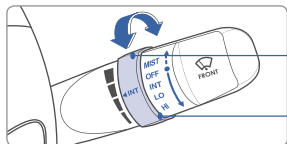

- Fast wiper speed
- Slow wiper speed



DRIVER'S MAIN CONTROLS

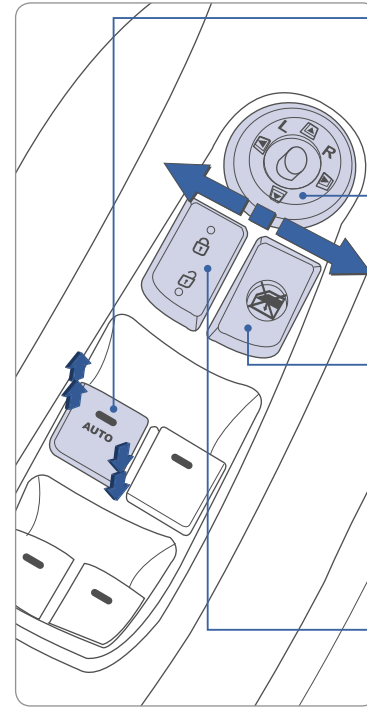

**Window Auto down/up
(driver's side only)**
Press past detent to fully open/close window.

Outside Rearview Mirrors
Press L (left) or R (right) on the switch. Then adjust the mirror by using the directional switch.

Power Window Lock Switch
Disables the power window switches on the passenger doors.

- **Lock**
Press the switch. (pressed in)
- **Unlock**
Press the switch again. (pressed out)

Door Lock
Locks/unlocks all doors.



FEATURES AND CONTROLS

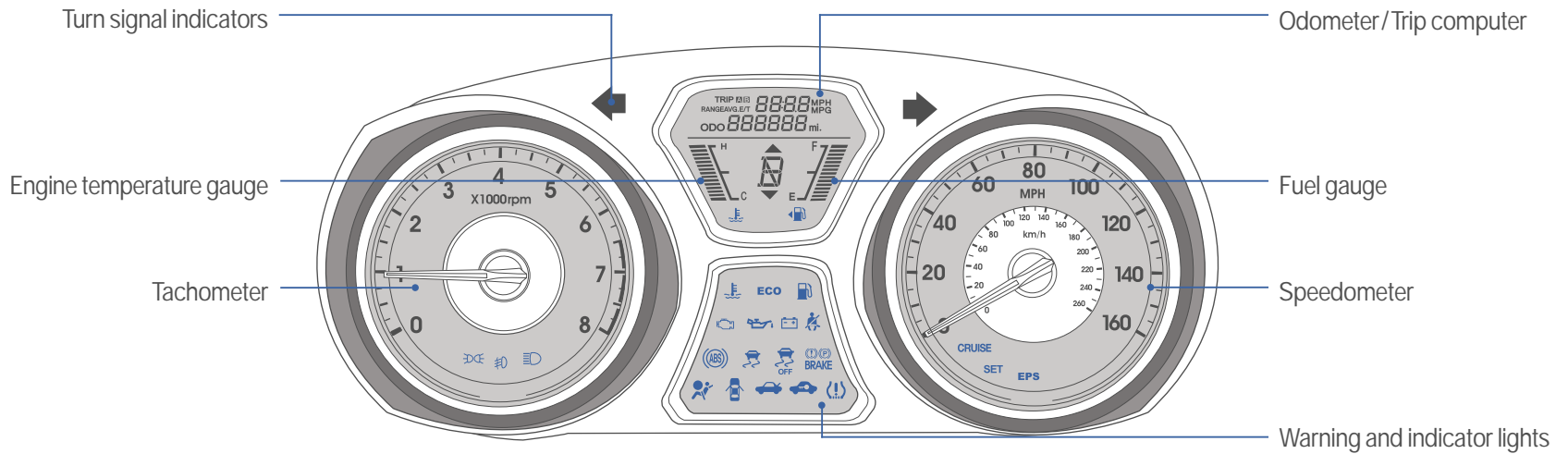

WARNINGS AND INDICATORS

Air bag warning light	Parking brake & Brake fluid warning light	ABS warning light
Seat belt warning light	Low Tire Pressure Indicator / TPMS (Tire Pressure Monitoring System) malfunction indicator	
High beam indicator	Engine oil pressure warning light	Charging system warning light
Electric Power Steering system warning light	Door open warning light	Turn signal indicator
Immobilizer indicator	Automatic transmission shift indicator	Manual transmission shift indicator
Trunk open warning light	Low fuel level warning light	ESC (Electronic Stability Control) indicator
ESC (Electronic Stability Control) OFF indicator	Cruise indicator	Cruise SET indicator
Malfunction indicator light	Front fog light indicator	ECO indicator
Light on indicator	Engine coolant temperature warning light	

INSTRUMENT PANEL ILLUMINATION

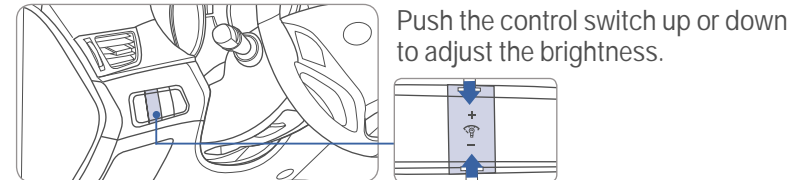

TRIP COMPUTER

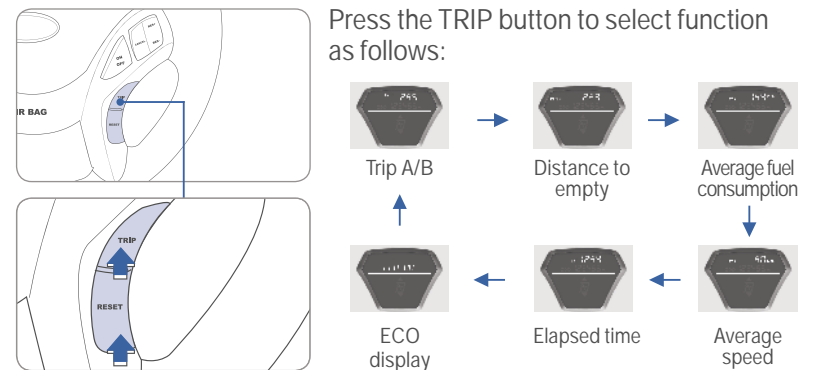



FEATURES AND CONTROLS

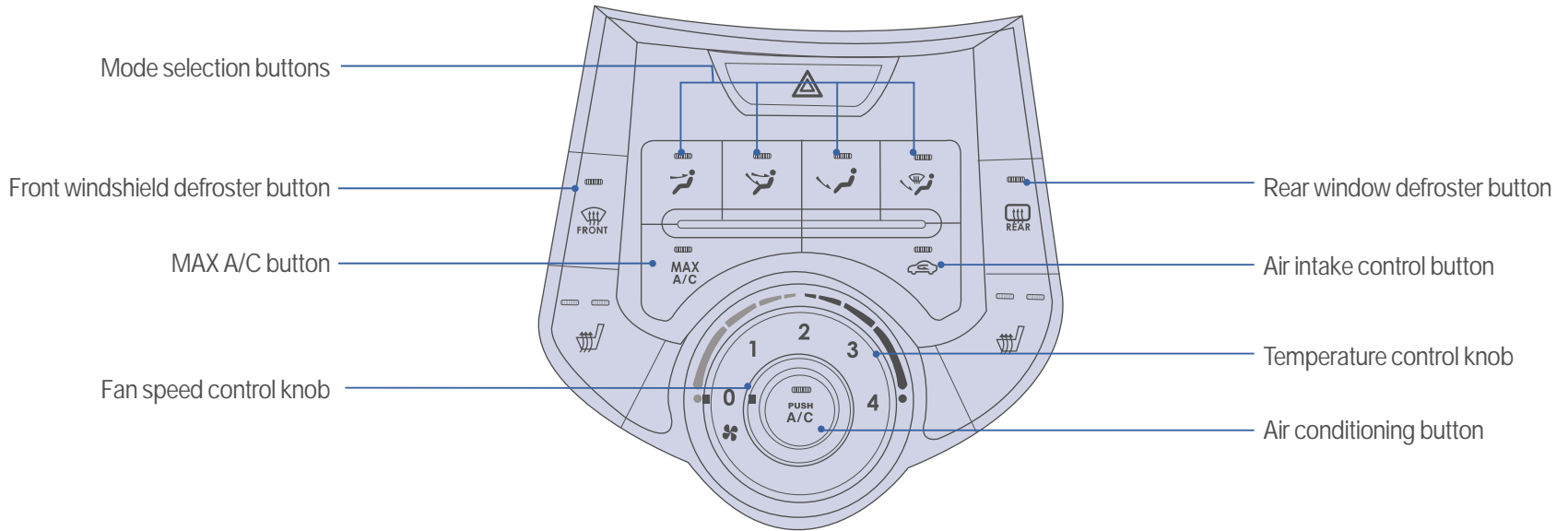

DEFROSTING / DEFOGGING

1. Press the front windshield defrost control.
2. Set the temperature control to the warmest setting.
3. Set the fan speed to the highest setting.

NOTE

To reduce tendency of the glass fogging and also to improve visibility, keep the interior surface of the windshield clean by wiping it with a clean cloth and glass cleaner.

AIR INTAKE CONTROL

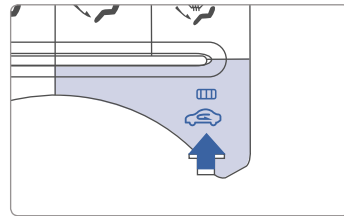

- Outside (fresh) air position
- Recirculated air position

MODE SELECTION

- Face Level
- Bi-Level
- Floor Level
- Floor & Defrost Level
- Defrost Level

REAR WINDOW DEFROSTER

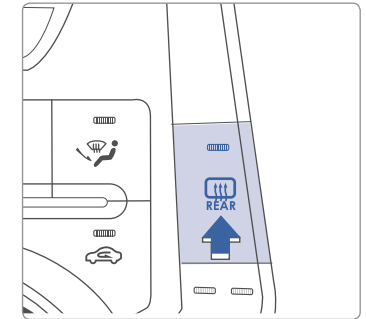

Press to activate/deactivate the rear window defroster.



MULTIMEDIA

STANDARD RADIO

Audio

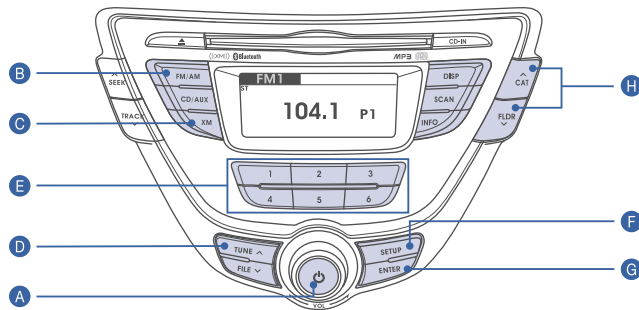

Press **POWER** button **A** to turn radio on.

TUNING/LISTENING TO CHANNELS

1. Press **FM/AM** **B** or **XM** **C**.
2. Press **TUNE/FILE** **D** switch up or down to desired channel.

NOTE A clear view of the southern sky helps to ensure **XM** radio reception.

SETTING PRESET MEMORY BUTTONS (FM/AM/XM)

Press and hold any preset button (1-6) **E** until audible beep is heard to store current channel.

ADJUSTING THE SOUND CONTROL

1. Press **SETUP** **F**.
2. Move to "Audio" item by rotating **VOLUME** **A** knob; then press **ENTER** **G** to select.
3. Select "Bass / Mid / Tre / Fad / Bal" by rotating **VOLUME** **A** knob; then press **ENTER** **G** to select.
4. Rotate **VOLUME** **A** knob to adjust; then press **ENTER** **G**.
5. Press **SETUP** **F** when done.

Steering wheel audio control

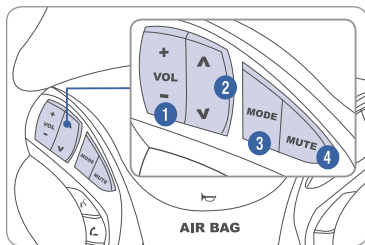

1. **Volume**
Raises or lowers speaker volume.
2. **Seek/Preset**
Change station.
3. **Mode**
Change the audio source.
4. **Mute**
Mute the sound.

Please refer to your Owner's Manual for more detailed information on how to use your audio system. Complimentary **XM** subscription ends three months following the vehicle date of sale. Please contact **XM** Radio at 1-800-XM-RADIO (1-800-967-2346) to renew your **XM** subscription.



BLUETOOTH PHONE OPERATION

Phone setup (pairing phone) with Audio

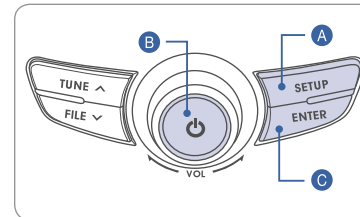

1. Push the **SETUP** button **A**.
2. Select "Phone" item by rotating the **VOLUME** knob **B**, then press **ENTER** **C**.
3. Select "Pair" by rotating the **VOLUME** knob **B**, then press **ENTER** **C**.
4. Enable Bluetooth on your phone.
5. Select "ELANTRA" on your mobile phone from the Bluetooth list.
6. Input passkey displayed on the screen.

Phone setup (pairing phone) with Navigation

1. Press the call button **1**.
2. Press the "Settings" button on the PHONE screen.
3. Press the "Pairings" button on the SETTINGS screen.
4. Press the **2** "Add to" button to pair a new mobile phone.
5. Enable Bluetooth on your phone. Input the passkey set within the car system into the mobile phone input window. (The initial passkey is 0000.)
6. Bluetooth connection is successful.

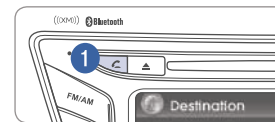

3. Press the "Pairings" button on the SETTINGS screen.

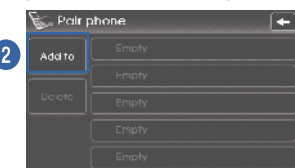

5. Enable Bluetooth on your phone. Input the passkey set within the car system into the mobile phone input window. (The initial passkey is 0000.)

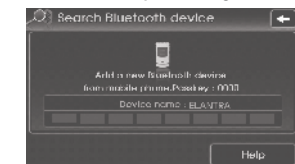

6. Bluetooth connection is successful.



NOTE

Vehicle must be in park to complete pairing process.



MULTIMEDIA



NAVIGATION

Audio mode

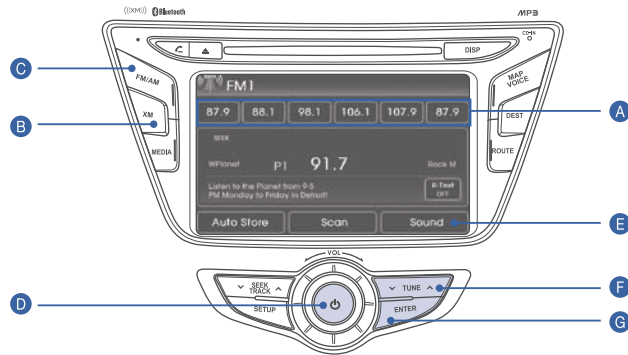

Press POWER button **D** to turn radio on.

• TUNING/LISTENING TO CHANNELS

1. Press FM/AM **C** or XM[®] **B**.
2. Press TUNE button **F** to desired channel.

NOTE

A clear view of the southern sky is recommended to ensure XM[®] radio reception.

• SETTING PRESET MEMORY BUTTONS (FM/AM/XM[®])

Press and hold any preset button (1-6) **A** on the screen until audible beep is heard to store current channel.

• ADJUSTING THE SOUND CONTROL

1. Press Sound **E** to enter SETUP menu.
2. Press on-screen arrows to adjust desired setting.



• SELECTING TRACK THROUGH SEARCH (CD/USB MODE)

1. Press the ^ TUNE ∨ button **F** to search for desired display track.
2. Press the ENTER button **G** to select the desired track.

Map position

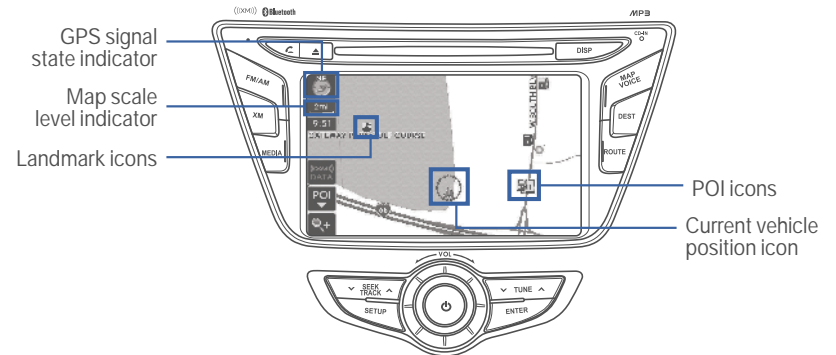

Destination menu

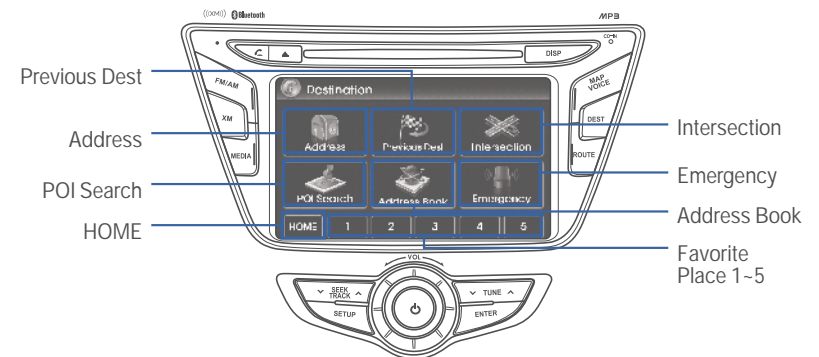



FUEL FILLER LID

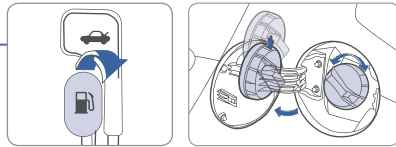
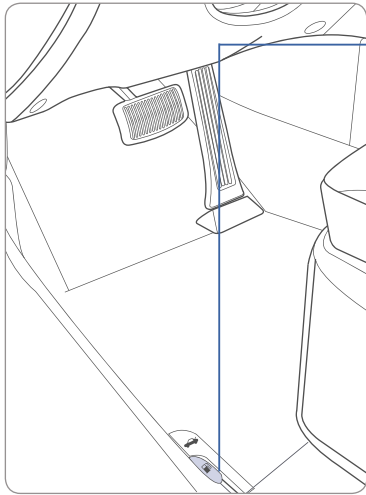

NOTE

After adding fuel, always reinstall the fuel cap onto the filler neck by rotating it clockwise until it clicks one time.
Failure to do this may result in the Check Engine Light illuminating.

CHILD-PROTECTOR REAR DOOR LOCK

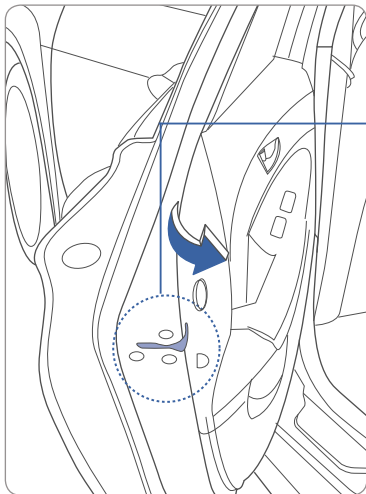

Lock (🔒)

Insert a key into the hole and turn it to the lock (🔒) position.

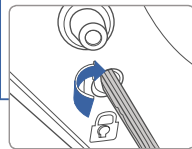

Unlock (→)

Allows opening the rear door handle from inside and outside the vehicle.

SUNROOF

Sliding the sunroof

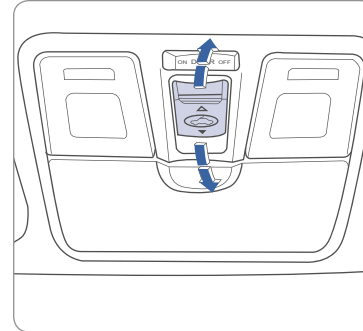

Open

Press switch rearward.
Press switch rearward past the detent to open completely.

Close

Press switch forward.
Press switch forward past the detent to close completely.

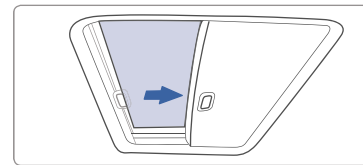

Tilting the sunroof

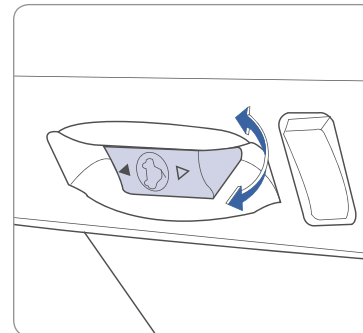

Tilt

Push or pull switch up or forward.

NOTE

Do not leave the sun shade closed while the sun roof is open.

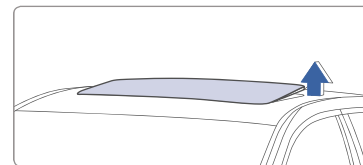



FEATURES AND CONTROLS



SEAT WARMER

Front seat

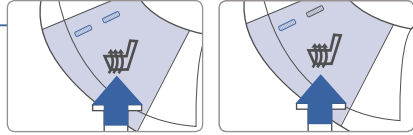
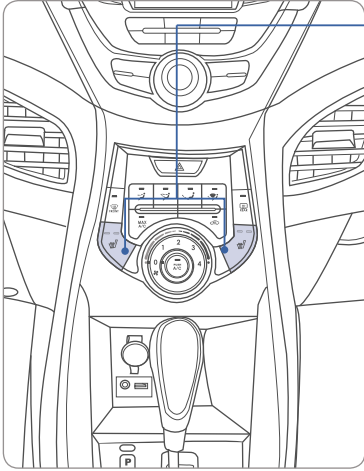

Push desired switch to warm the seat.

OFF → HIGH () → LOW ()

Rear seat



Push the switch to warm the seat.
Push switch again to turn off.

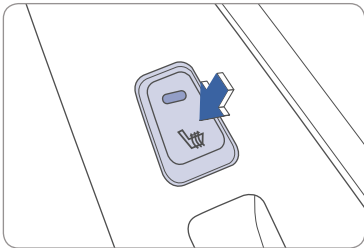

CLOCK ADJUSTMENT

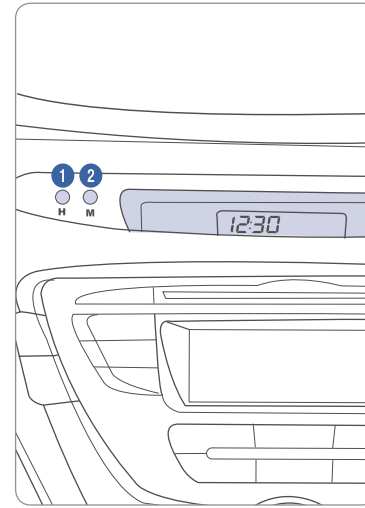

Hour 1

Pressing the H button will advance the time displayed by one hour.

Minute 2

Pressing the M button will advance the time displayed by one minute.

Press the H and M buttons at the same time for more than 5 seconds to toggle between 12- and 24- hour formats.

INTERIOR LIGHTS

Map lamp

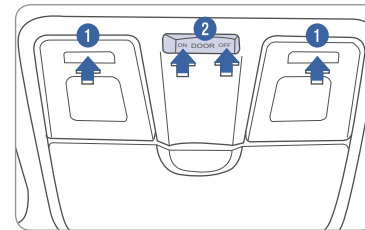

Push the lens 1 to turn the map lamp on or off.

Switch 2

ON

Map lamp and room lamp will turn on.

DOOR

Map lamp and room lamp will turn on when any door is open except trunk.

Room lamp

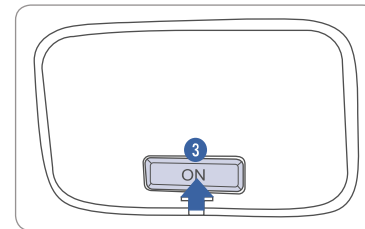

OFF

The lights stay off at all times, except when individually turned on.

Switch 3

ON

Room lamp will turn on or off.



FEATURES AND CONTROLS



REARVIEW CAMERA

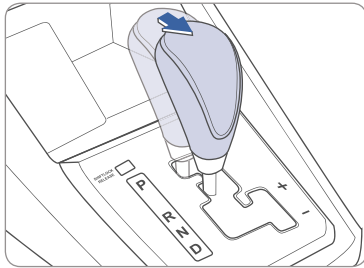

The rearview camera will activate when the ignition switch is turned ON and the shift lever is in the R (Reverse) position.

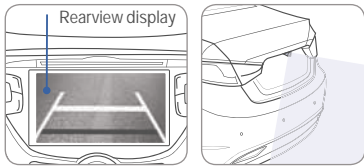

AUX, USB AND iPod® PORT

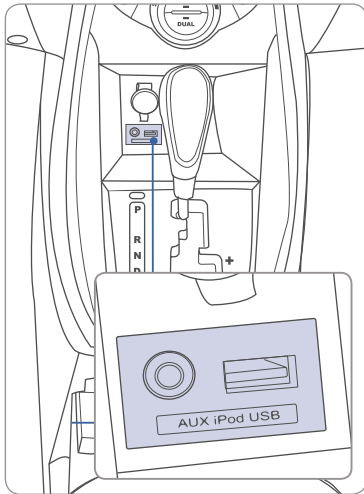

Use the jack to connect an external audio device and listen to it through the audio system speakers in your vehicle.

NOTE

To operate your iPod® through the vehicle's audio system, a Hyundai adapter cable is required. This cable can only be purchased at your local Hyundai dealer.

iPod® is a trademark of Apple Inc.

TIRE PRESSURE MONITORING SYSTEM (TPMS)

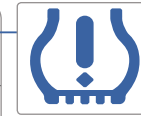
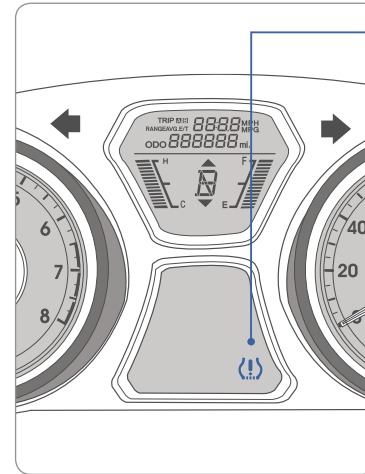

Low Tire Pressure Indicator /
TPMS Malfunction Indicator

Low Tire Pressure Indicator

Illuminates if one or more of your tires is significantly under-inflated.

TPMS Malfunction Indicator

Blinks for approximately one minute then remains illuminated when there is a malfunction with the TPMS system. Have the system checked by an authorized Hyundai dealer.

NOTE

Tire pressure may vary in colder temperatures causing the low tire pressure light (⚠) to illuminate.



MANUAL TRANSMISSION

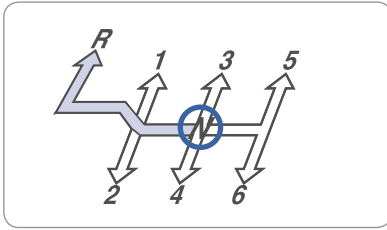
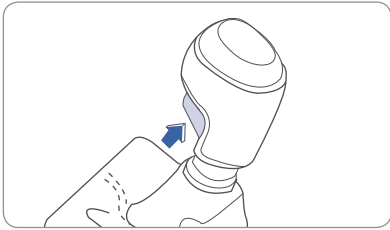
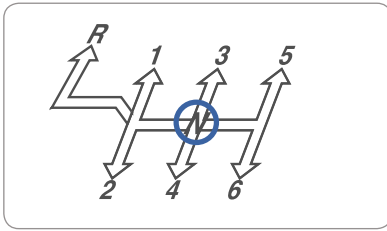
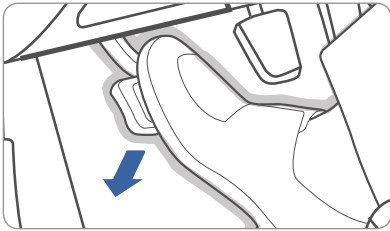

Shifting into reverse

1. Depress the clutch pedal fully.
2. Ensure shifter is in Neutral.
3. Press the reverse lock-out button and shift left to Reverse.
4. Release clutch slowly for smooth acceleration.

AUTOMATIC TRANSMISSION

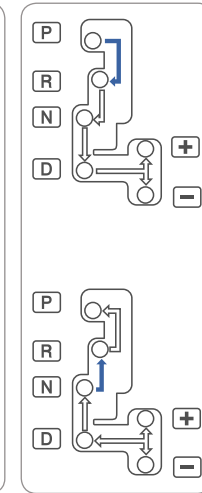
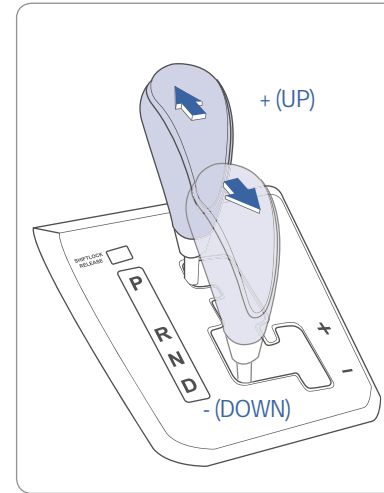

(➡) : Depress the brake pedal when shifting.

(⇔) : The shift lever can be moved freely.

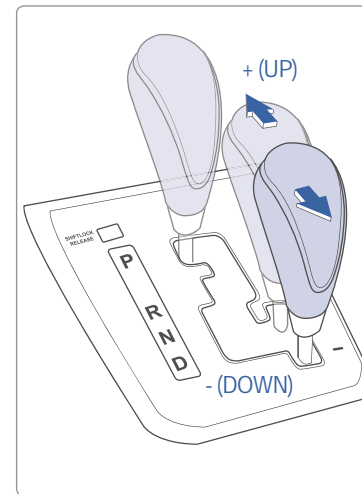

Sport mode

Move the shift lever from D to the right gate to select.
 Move the shift lever forward (+) to upshift or rearward (-) to downshift.



ELECTRONIC STABILITY CONTROL (ESC)

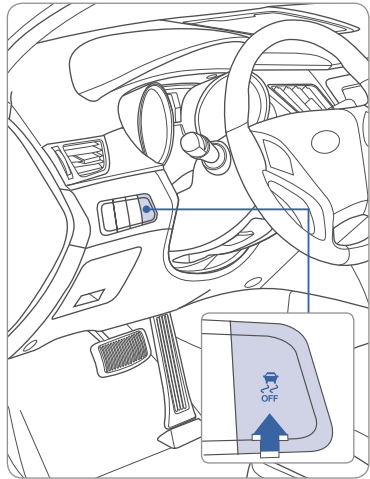

The ESC system is an electronic system designed to help the driver maintain vehicle control under adverse conditions.

- To turn the ESC off, press the ESC OFF button.
- To turn ESC on, press it again.
- System defaults to ON position at start.

ECO SYSTEM

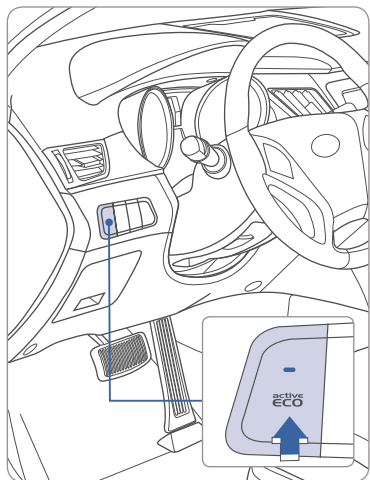

Active ECO system (automatic transmission)

Active ECO system helps improve fuel efficiency by controlling the engine and transmission.

Press to activate. An LED will illuminate on the button and the ECO indicator will illuminate in the Instrument Cluster.

Press again to deactivate.

ECO shift indicator (manual transmission)

The ▲ or ▼ symbol is displayed along with the recommended gear number, indicating you should upshift or downshift for higher fuel efficiency.



CRUISE CONTROL SYSTEM

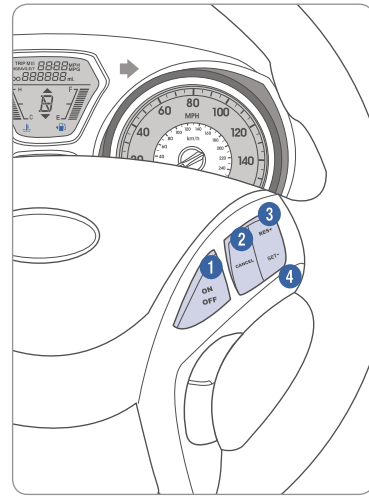

CRUISE Cruise indicator

SET Cruise set indicator

To set a cruising speed

1. Press ON/OFF button ① and the CRUISE indicator will illuminate in the instrument cluster. Accelerate to desired cruising speed (above 25 mph).
2. Press SET- button ④ and remove your foot from the accelerator pedal.

To accelerate or decelerate

Press RES + button ③ up to increase set cruising speed.
Press SET - button ④ down to decrease set cruising speed.

To cancel cruising speed

Press CANCEL button ②, depress brake pedal, or press ON/OFF button ①.

Key Websites

Hyundai website - www.hyundai.com

Hyundai owner website - www.myhyundai.com

Bluetooth phone compatibility - www.hyundaiusa.com/bluetooth

ELANTRA CUSTOMER DELIVERY CHECK LIST

HYUNDAI OWNER	DEALERSHIP NAME
SALES CONSULTANT	DATE
VIN	PREVIOUS VEHICLE

BEFORE DELIVERY

- CONFIRM "GOOD BATTERY" USING GR8 AND STAPLE TEST TICKET HERE
- CONFIRM COLD TIRE PRESSURE IS SET TO PLACARD
- CONFIRM SHIPPING FUSE IS IN POSITION
- VERIFY VEHICLE IS CLEAN, IN GOOD CONDITION, FREE OF CHIPS AND SCRATCHES - CLEAN WINDSHIELD AND BACK WINDOW
- ENSURE FLOORMATS ARE SNAPPED INTO PLACE (if applicable)

WALK THE CUSTOMER THROUGH EACH OF THE FOLLOWING KEY DELIVERY FEATURES

- Defrost - page 10
 - ① Press the front defrost button.
 - ② Set to warmest temperature setting.
 - ③ Set to highest fan speed.

▪ To speed up front windshield defogging, increase temperature, fan speed and then select defrost button.

